

ACCESSIBILITY GUIDE

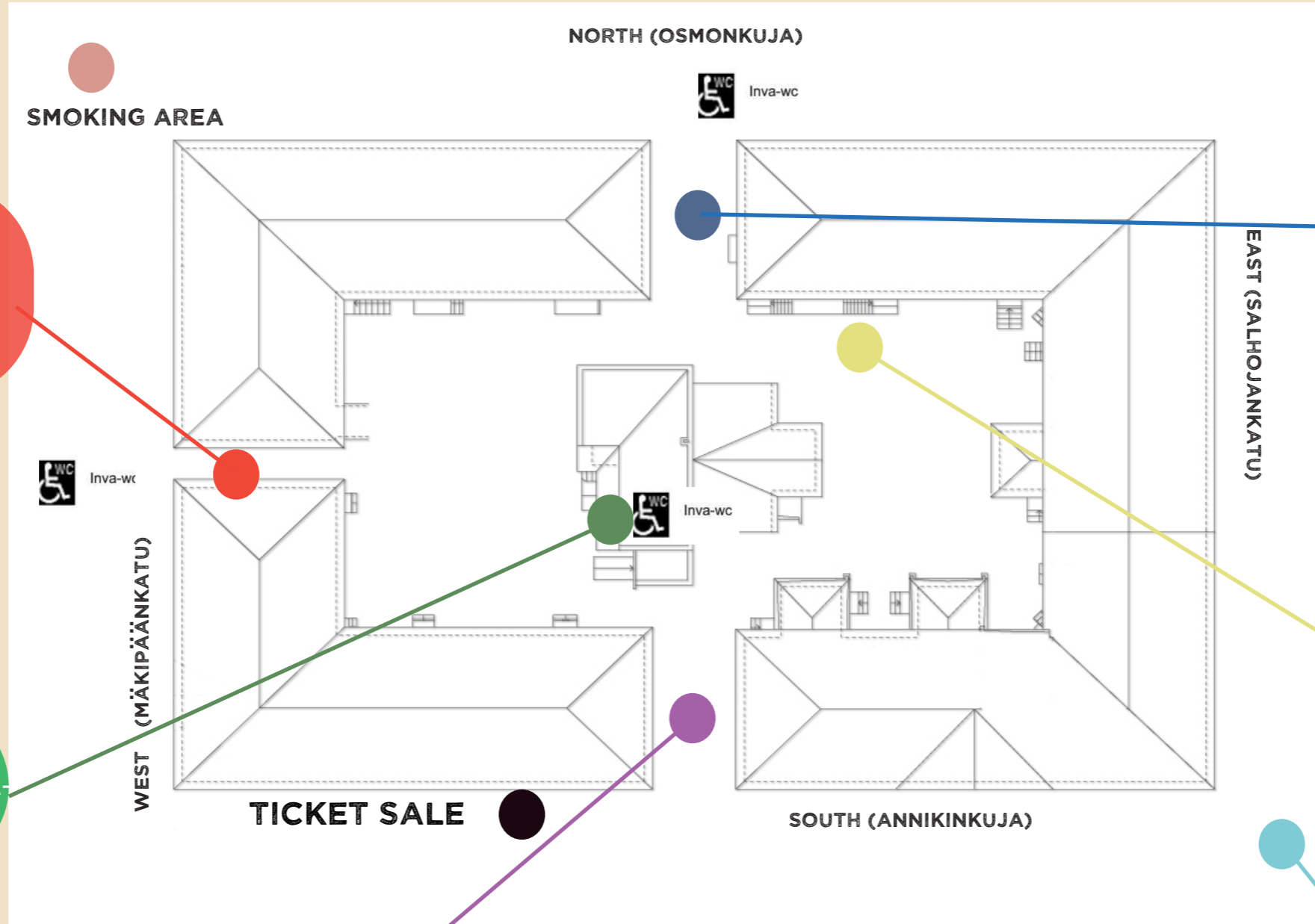

West entrance on the side of Mäkipäänkatu and Osmonpui-
to. Annikki Festival Park has one
accessible wc.



There are chemical toilets outside
the North gate. One of them is easily
accessible.



The area reserved for wheelchairs is
located on the stone terrace behind the
rest of the audience.



The Art Kiosk is not wheelchair
accessible, but the exhibition
can be seen from the door.



The toilet below the balcony
stage has handrails and a wheel-
chair ramp.



There is a steep slope by the entrance and the ticket sale. If
necessary, we can guide our customers with reduced mobility
through the west side gate.

ANNIKKI WOODEN HOUSE QUARTER

Visit address: Annikinkuja 2, 33500 Tampere



There are significant differences in elevation in the area.
We are happy to assist you upon request.